

LOCATION MAP

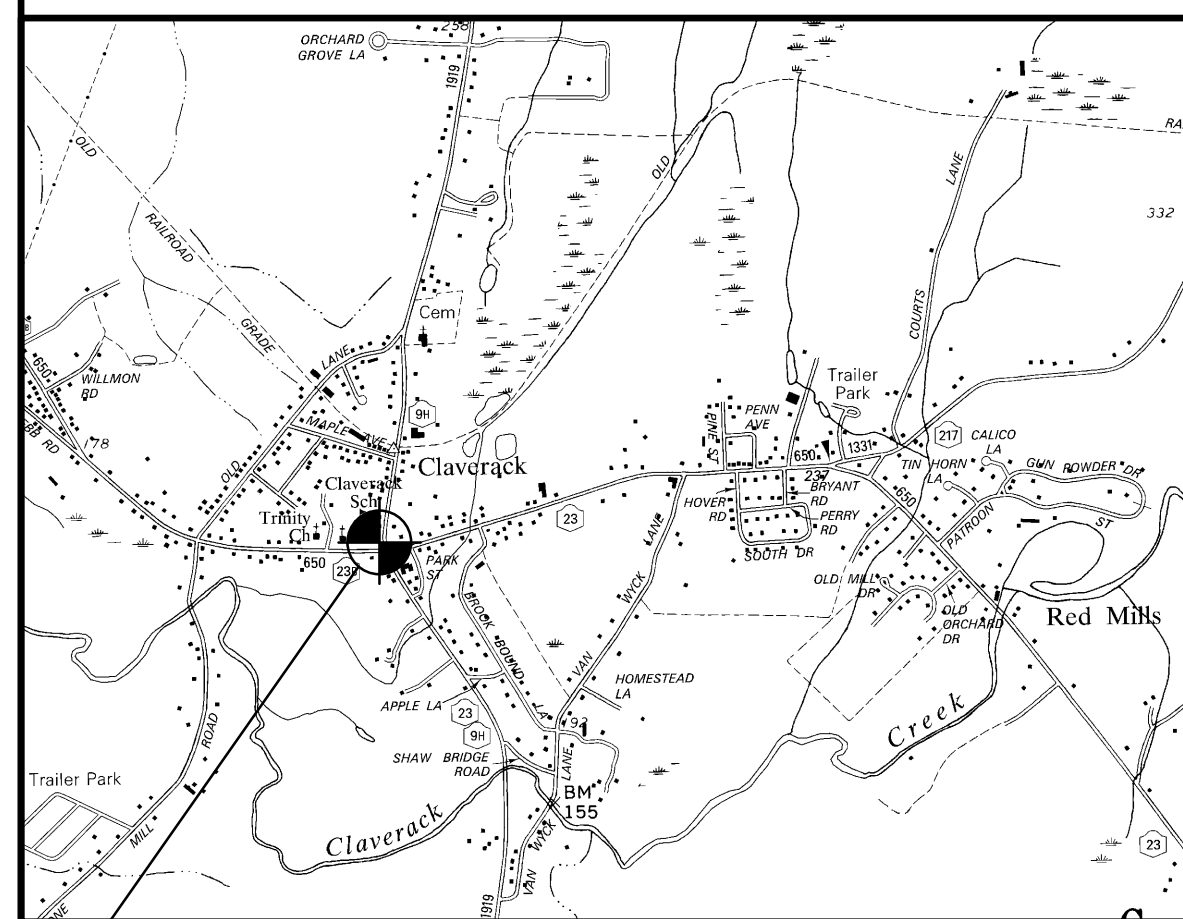

SITE LOCATION  
SCALE: 1" = 2000'

# CLAVERACK FREE LIBRARY NYS DOT ENTRANCE PLAN

PREPARED FOR:

CLAVERACK FREE LIBRARY  
629 ROUTE 23B  
CLAVERACK, NEW YORK 12513

PREPARED BY:

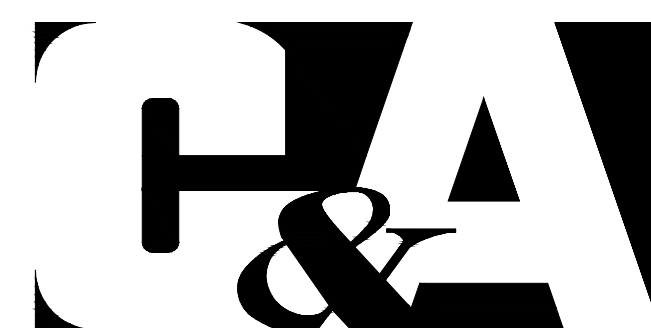

**CRAWFORD & ASSOCIATES**

ENGINEERING, P.C.

551 Warren Street, Hudson New York 12534, (518) 828-2700

C&A #: 4721.0

DATE: SEPTEMBER 19, 2011

REVISED: DECEMBER 22, 2011

SEPTEMBER 09, 2016

NOVEMBER 09, 2016

## DRAWINGS:

- T-1 - TITLE PAGE
- ENT-1 - PROPOSED MAINTENANCE & PROTECTION OF TRAFFIC PLAN
- ENT-2 - NYSDOT ENTRANCE DETAIL SHEET #1
- ENT-3 - NYSDOT ENTRANCE DETAIL SHEET #2

PRIOR TO BEGINNING CONSTRUCTION OF THE ENTRANCES, THE CONTRACTOR SHALL NOTIFY THE NYS DOT, JOSEPH VISCONTI, (518) 828-5137 TO REVIEW TRAFFIC MAINTENANCE & CONTROL PROCEDURES.

STATE LAW  
LICENSE SUSPENDED AFTER TWO WORK ZONE SPEEDING TICKETS  
NYRB-11

ROAD WORK AHEAD  
W20-1

NO SHOULDER  
W20-7

END ROAD WORK  
G20-2

- 111.10 PROPOSED SPOT ELEVATION
- + 1208.75 EXISTING SPOT ELEVATION
- PROPERTY LINE
- REQUIRED SETBACK LINE
- PARKING LOT STRIPING
- EXISTING/PROPOSED EDGE OF PAVEMENT
- EXISTING/PROPOSED DRIVEWAY
- EXISTING/PROPOSED SIDEWALK
- U --- U --- EXISTING/PROPOSED OVERHEAD ELECTRIC
- EXISTING/PROPOSED FENCE
- ST --- ST --- EXISTING/PROPOSED STORMWATER LINE
- S --- S --- EXISTING/PROPOSED SANITARY SEWER LINE
- EXISTING/PROPOSED HYDRANT
- EXISTING/PROPOSED UTILITY POLE
- EXISTING POLE MOUNTED LIGHTING
- EXISTING/PROPOSED WATER SHUT OFF
- EXISTING BUILDING
- EXISTING/PROPOSED SIGN
- EXISTING/PROPOSED DECIDUOUS TREE
- EXISTING/PROPOSED STORMWATER CATCH BASIN

- NOTES:
- SITE INFORMATION BASED ON SURVEY BY PLASS, ROCKEFELLER & NUCCI, LLC, PC TITLED, "SURVEY OF PROPERTY OF THE CLAVERACK FREE LIBRARY AND READING ROOM ASSOCIATION", DATED MAY 17, 2007 AND "SURVEY OF PROPERTY OF CLAVERACK FIRE DISTRICT", DATED MAY 7, 2007.
  - EXISTING ENTRANCE AND NYS ROUTE 9H & 23B DIMENSIONS AND CHARACTERISTICS FIELD VERIFIED BY CRAWFORD AND ASSOCIATES ON AUGUST 18, 2011.

SPEED (MPH)	INTERSECTION SIGHT DISTANCES - REQUIRED		
	B1 - LEFT TURN FROM MINOR RD LOOKING LEFT	B2 - RIGHT TURN FROM MINOR RD LOOKING RIGHT	B2 - RIGHT TURN FROM MINOR RD LOOKING LEFT
45	760'	760'	695'
40	676'	676'	618'
35	592'	592'	540'
30	508'	508'	463'

1. SIGHT DISTANCES OBTAINED FROM CHAPTER 9 OF AASHTO - GEOMETRIC DESIGN OF HIGHWAYS AND STREETS, FOR COMBINED TRUCK VEHICLES.

2. THE DESIGN SPEED USED TO DETERMINE THE LOCATION OF THE PROPOSED ENTRANCE IS 40 MPH, PER THE CURRENT MARKED SPEED LIMIT.

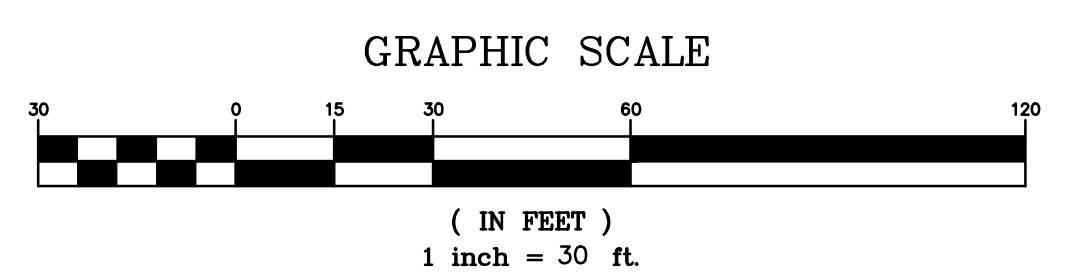
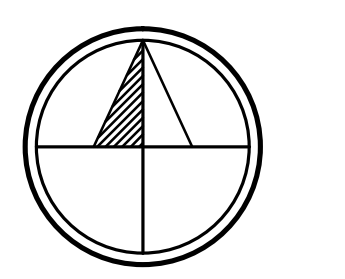

3	REVISED PER NYS DOT COMMENTS	11-09-16	ETY
2	REVISED PER UPDATED ITEM NUMBERS	09-09-16	ETY
1	REVISED PER DOT COMMENTS	12-22-11	CJK

**CLAVERACK FREE LIBRARY**  
TOWN OF CLAVERACK COLUMBIA COUNTY, NY  
PROPOSED MAINTENANCE AND PROTECTION OF TRAFFIC PLAN

**CRAWFORD & ASSOCIATES**  
ENGINEERING, P.C.  
551 Warren Street, Hudson New York 12534  
www.crawfordandassociates.com  
tel: (518) 828-2700  
fax: (518) 828-2723

DATE	DRAWN BY:	CJK	At: \WORK\4721.0\dwg\111.09.16 NYS DOT ENTRANCE.dwg
9/19/11	DESIGNED BY:	CJK	
SCALE	CHECKED BY:	APA	C&A JOB #
1" = 30'	APPROVED BY:	APA	4721.0
			DRAWING: ENT-1

IT IS A VIOLATION OF THE NEW YORK STATE EDUCATION LAW FOR ANY PERSON TO ALTER THESE PLANS, SPECIFICATIONS OR REPORTS IN ANY WAY, UNLESS HE IS ACTING UNDER THE DIRECTION OF A LICENSED PROFESSIONAL ENGINEER.

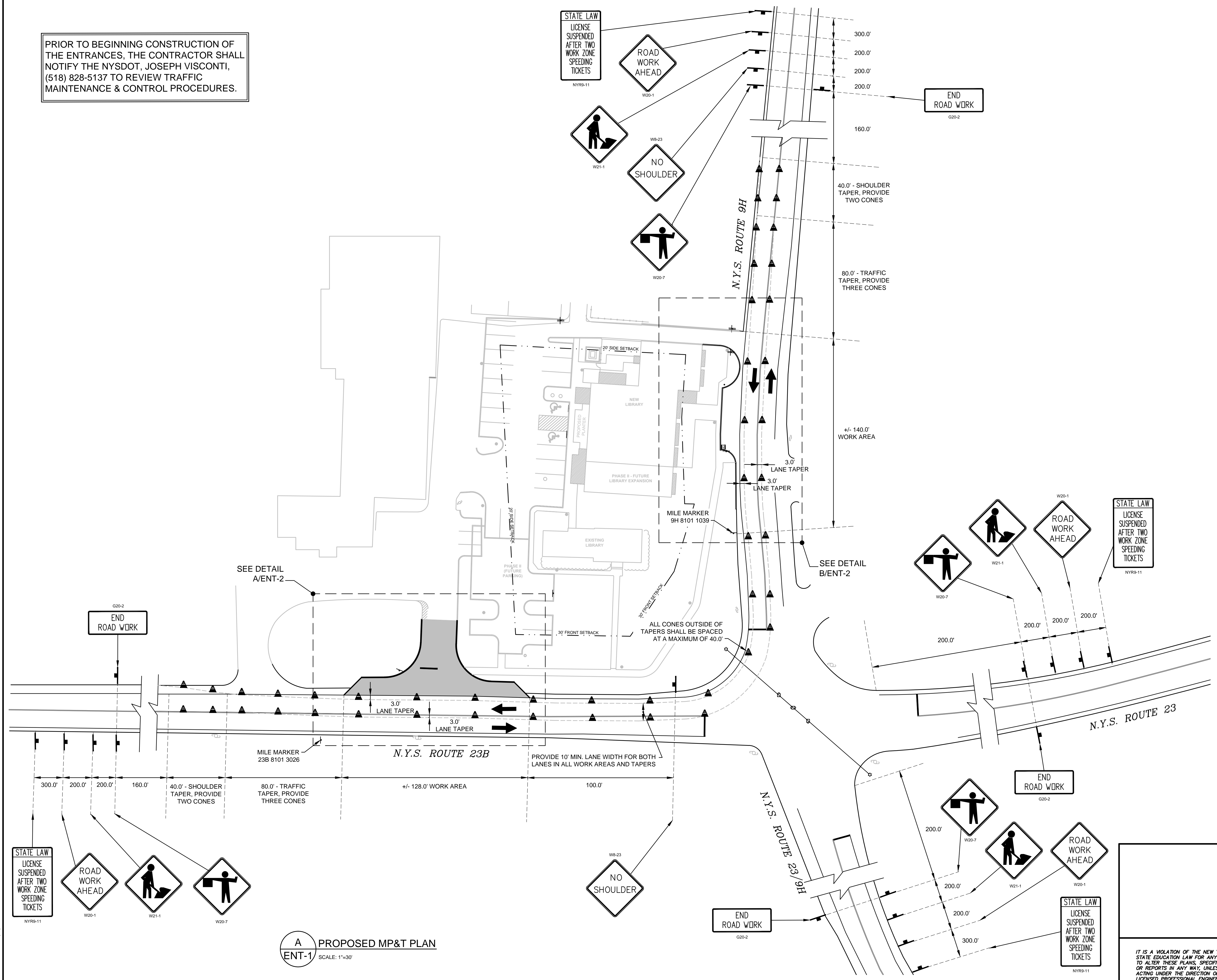

**A PROPOSED MP&T PLAN**  
ENT-1 SCALE: 1"=30'

11/10/2016 5:57 PM



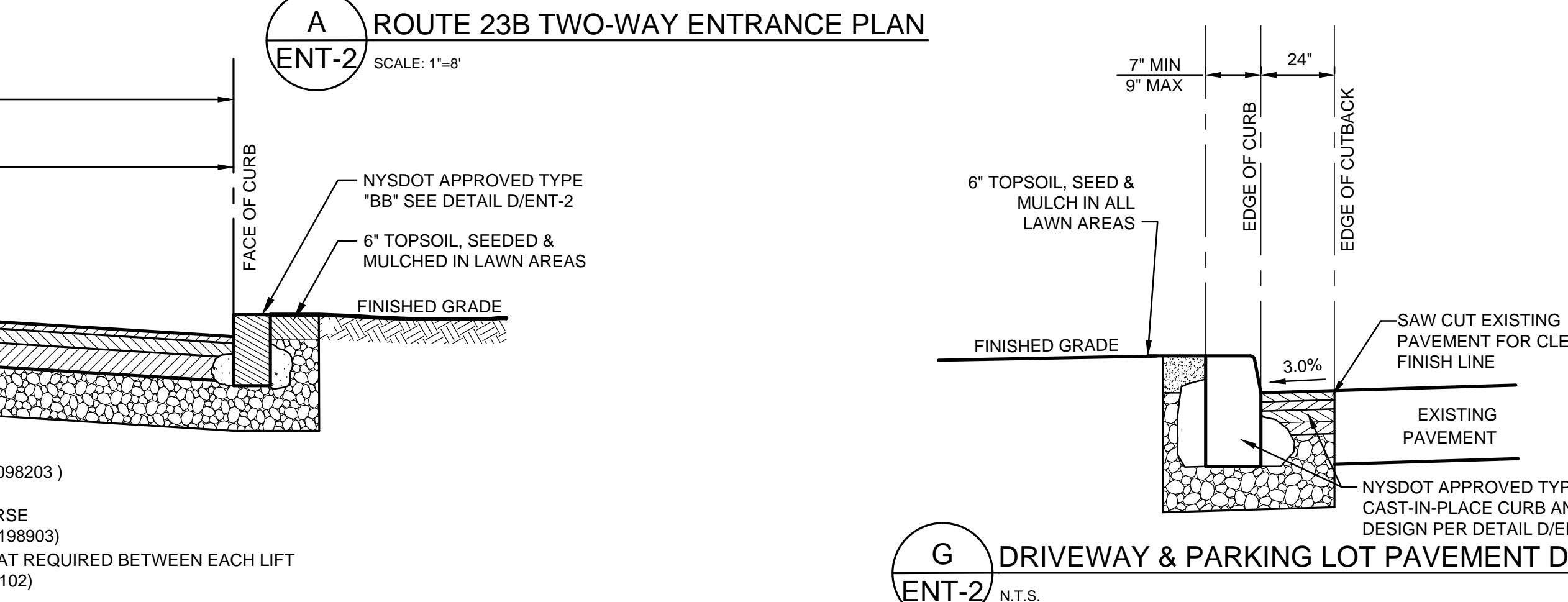
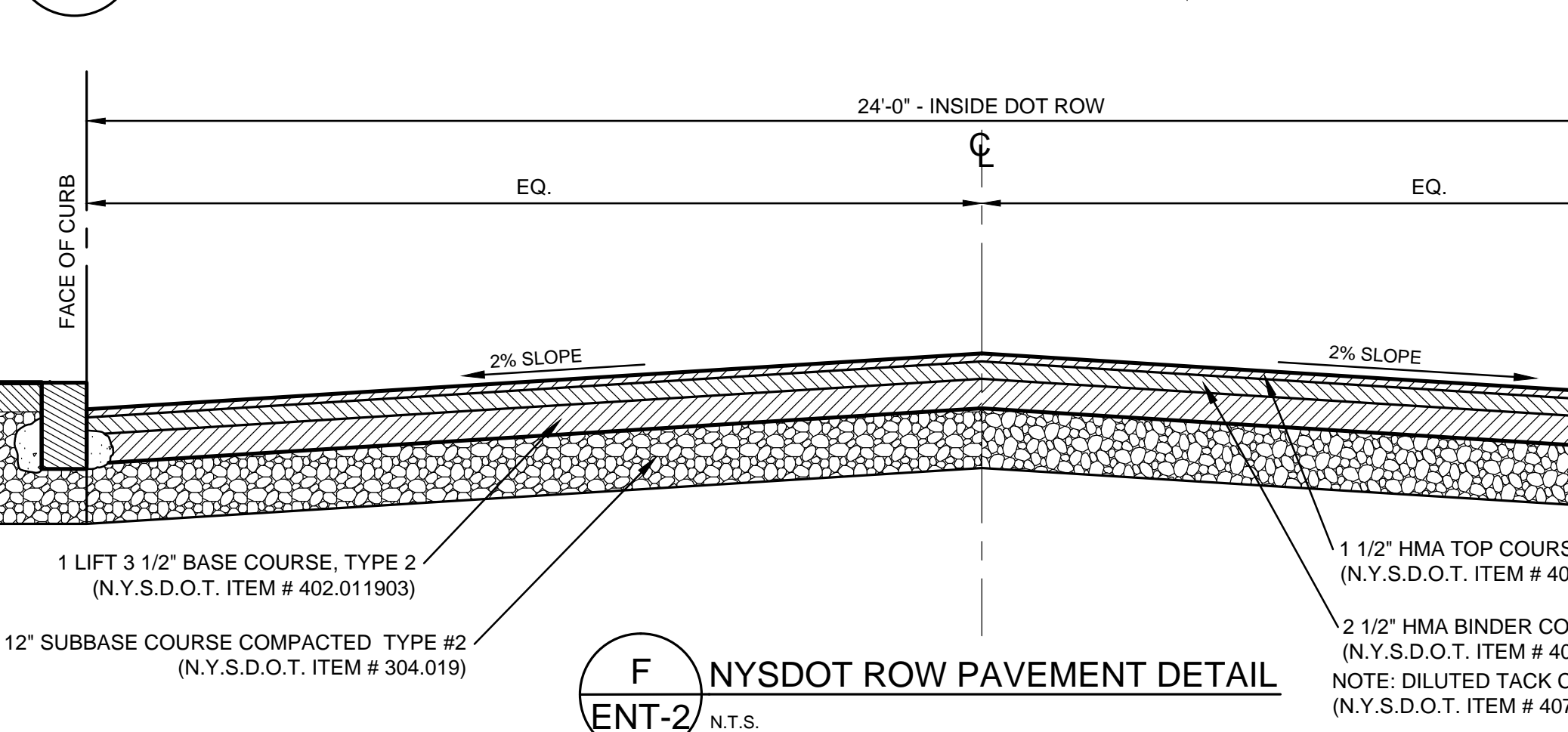
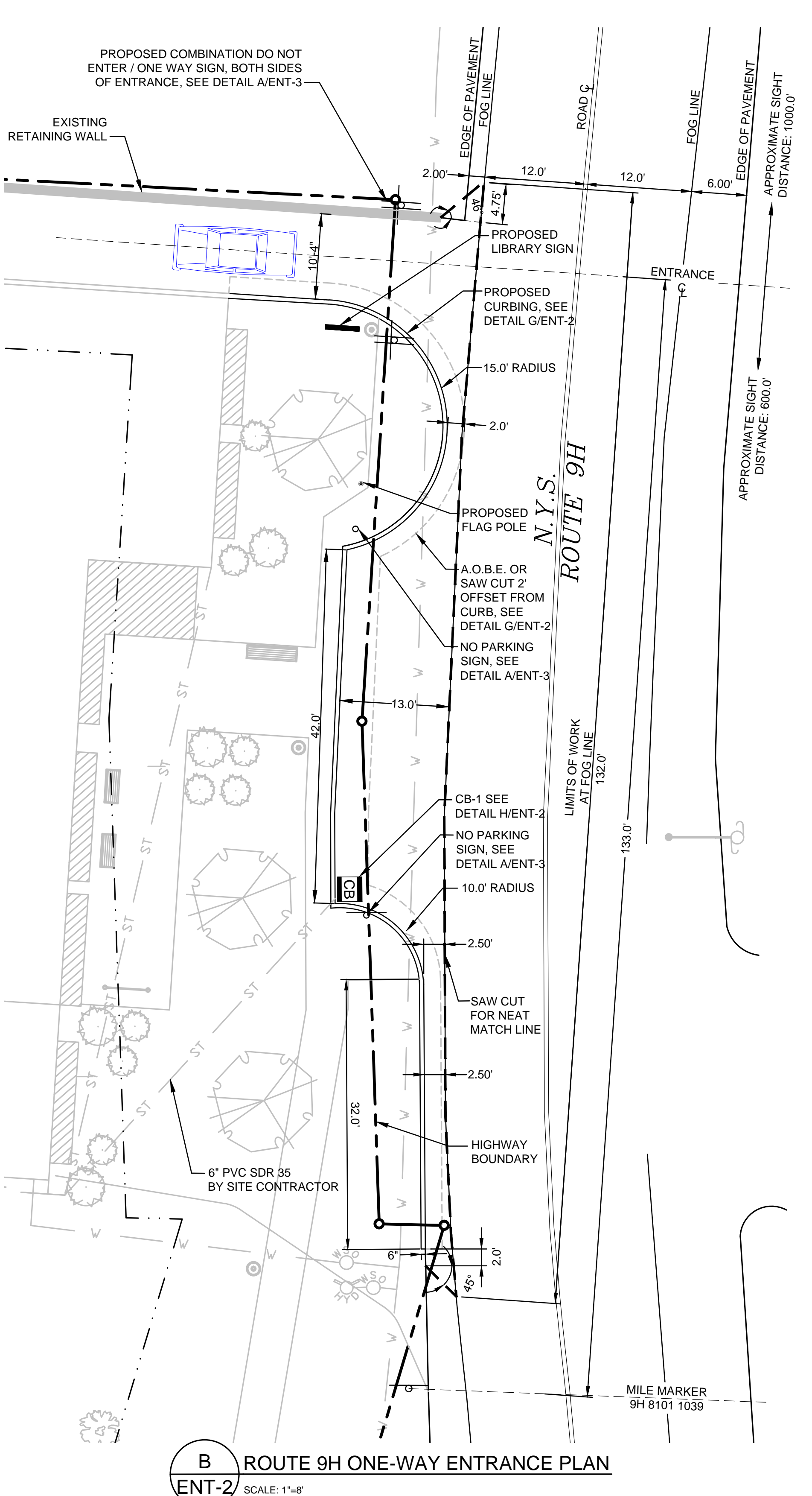
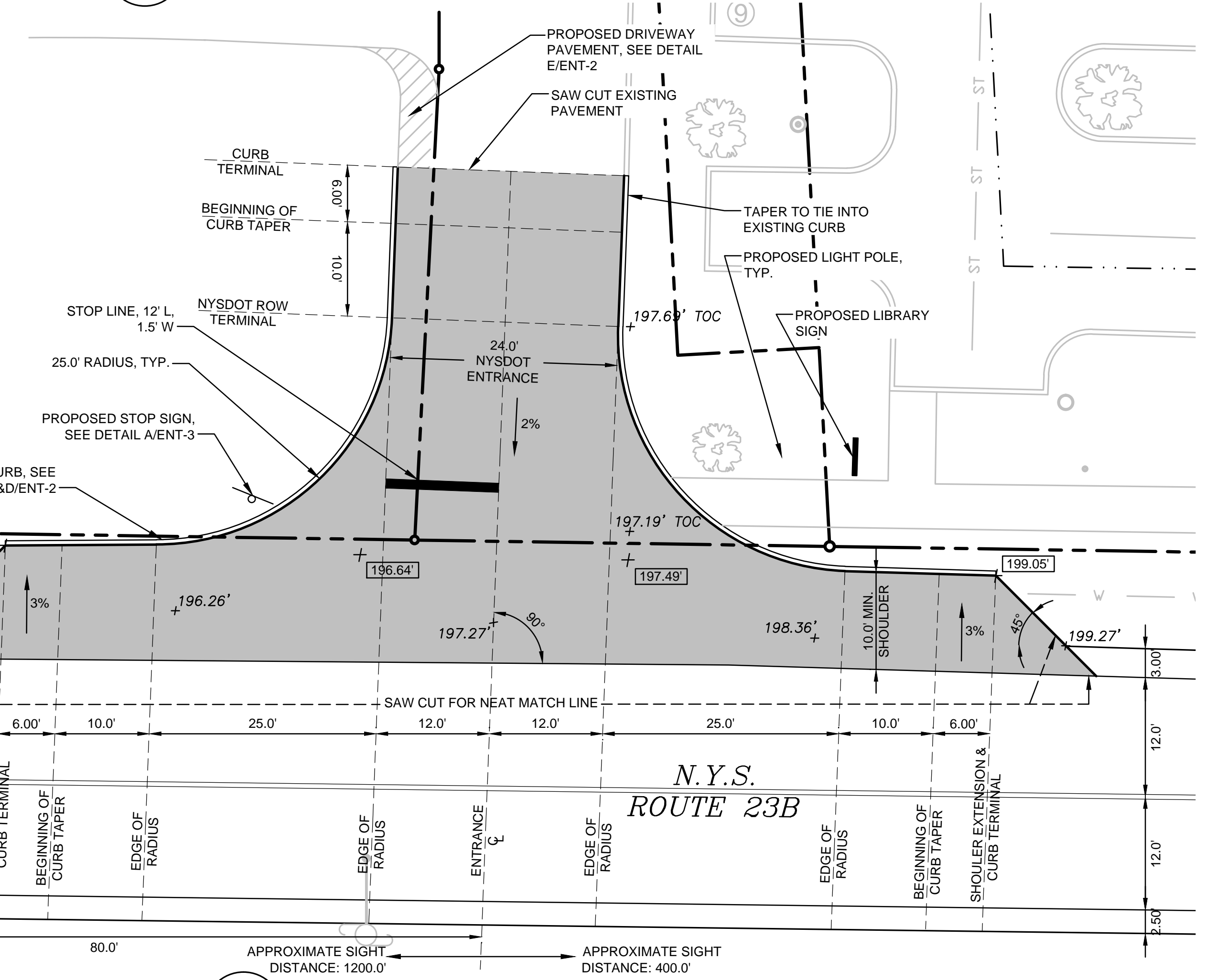
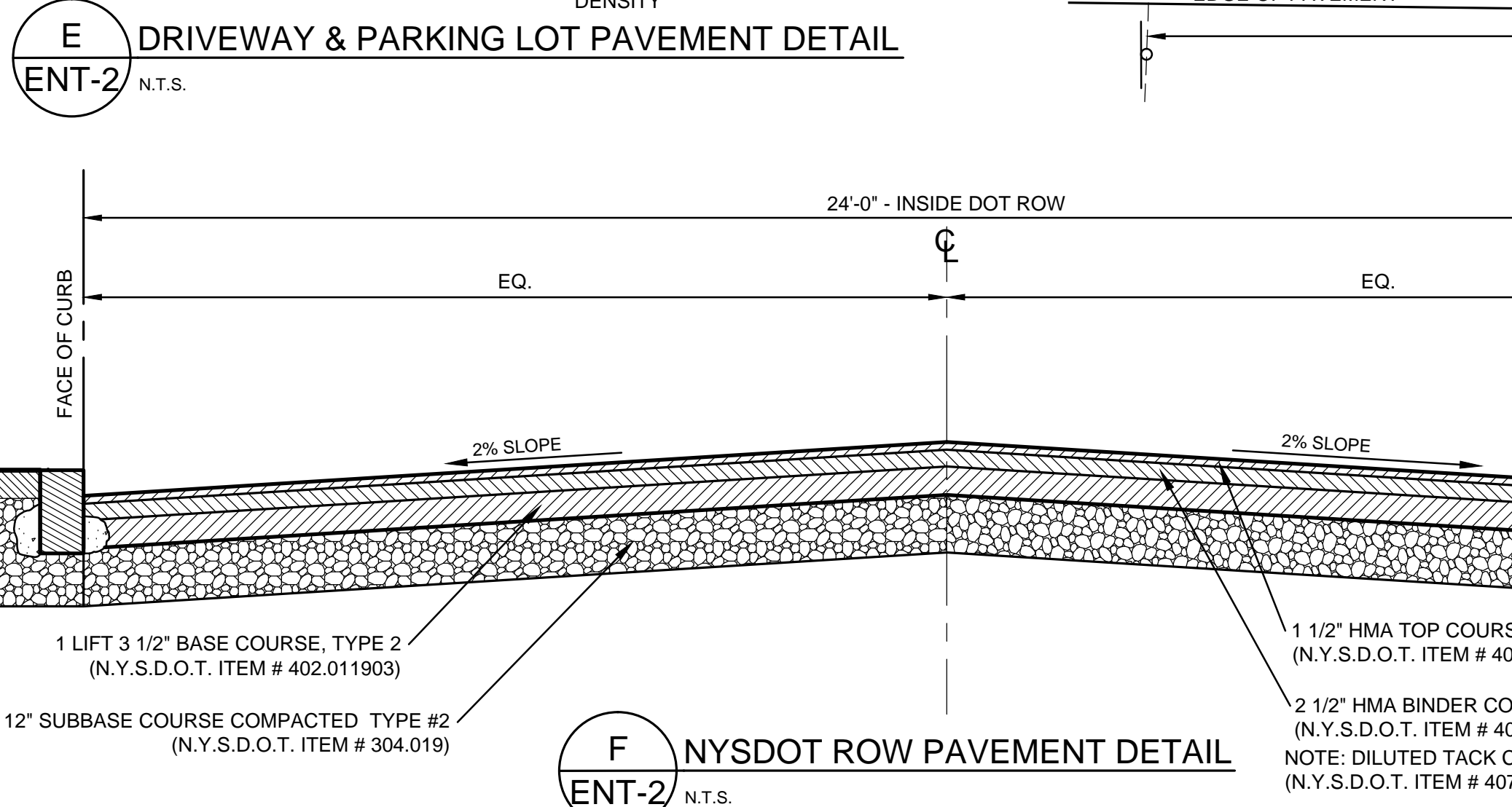
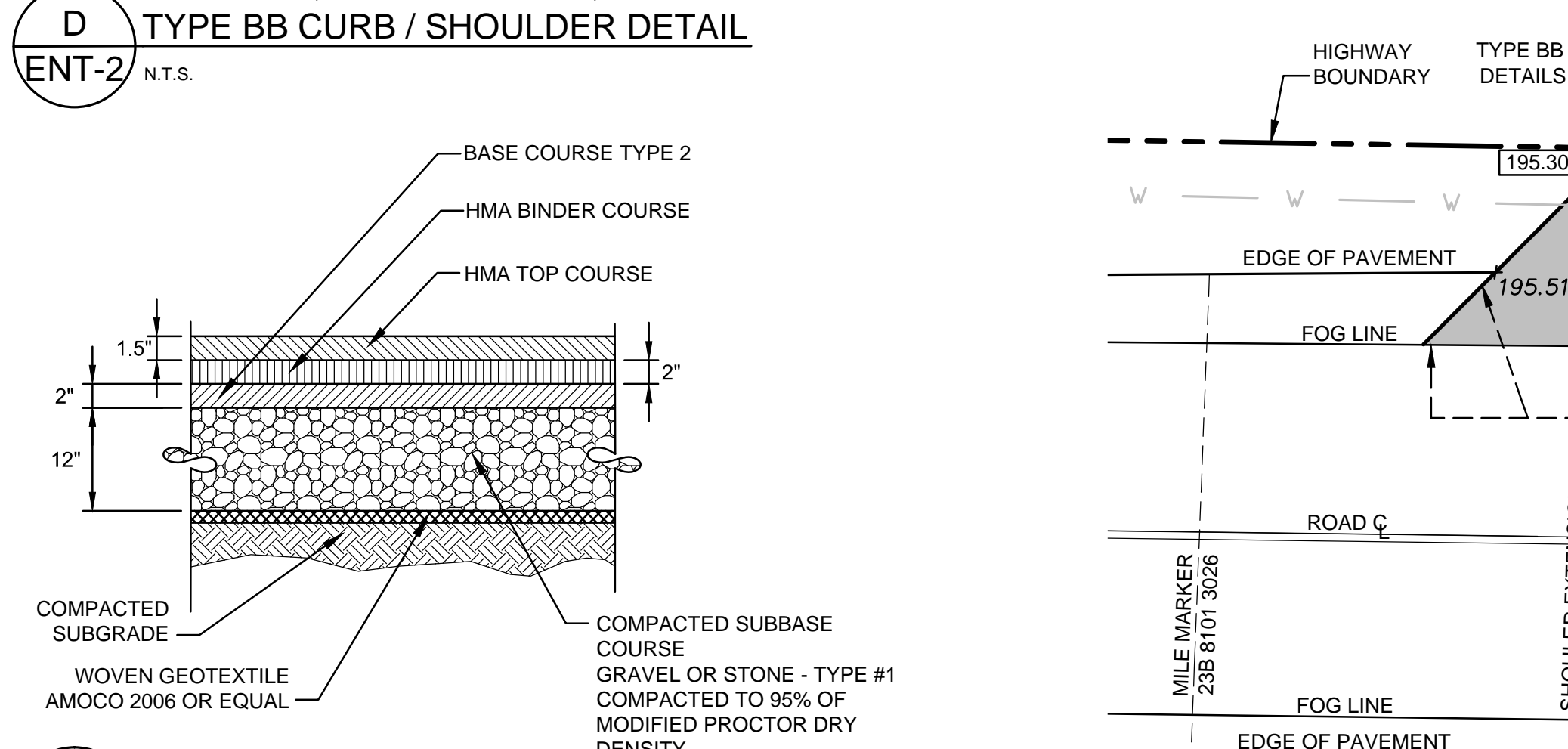
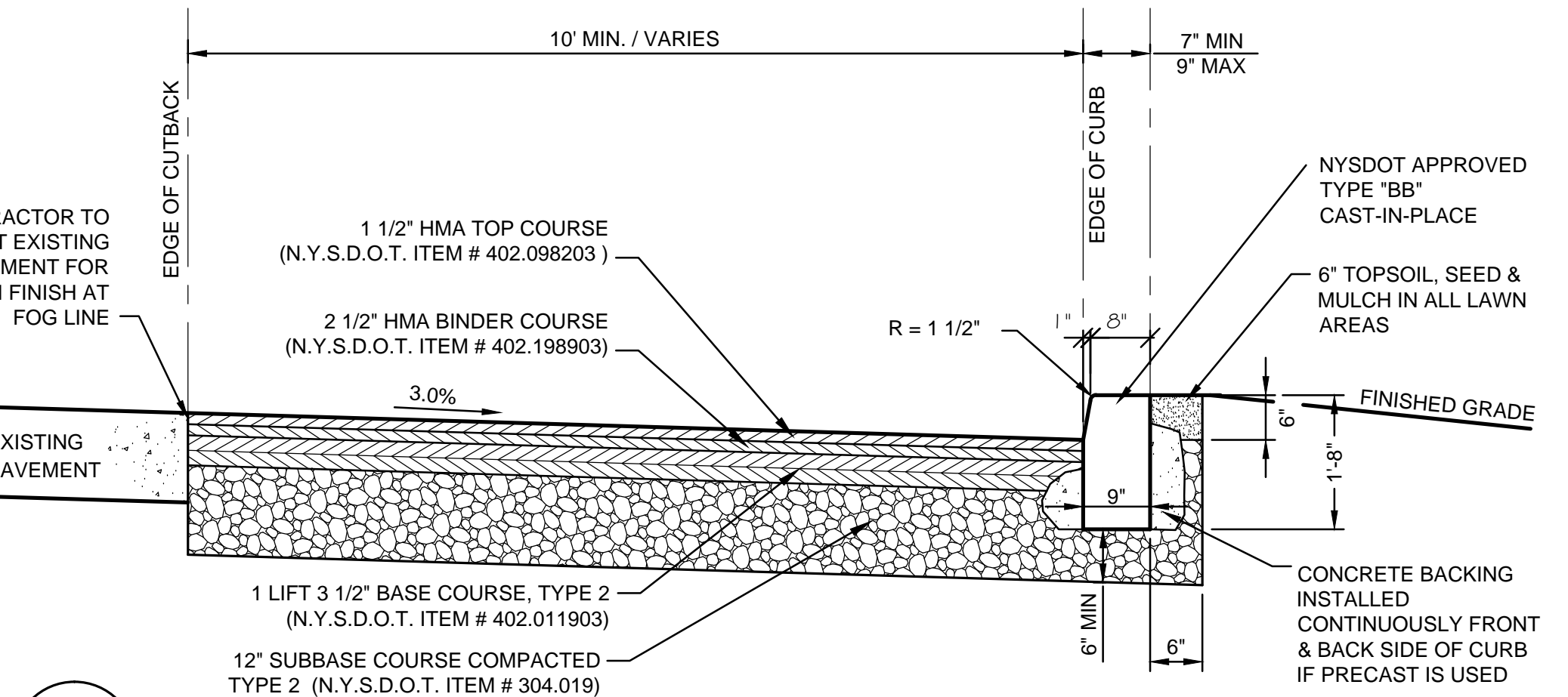
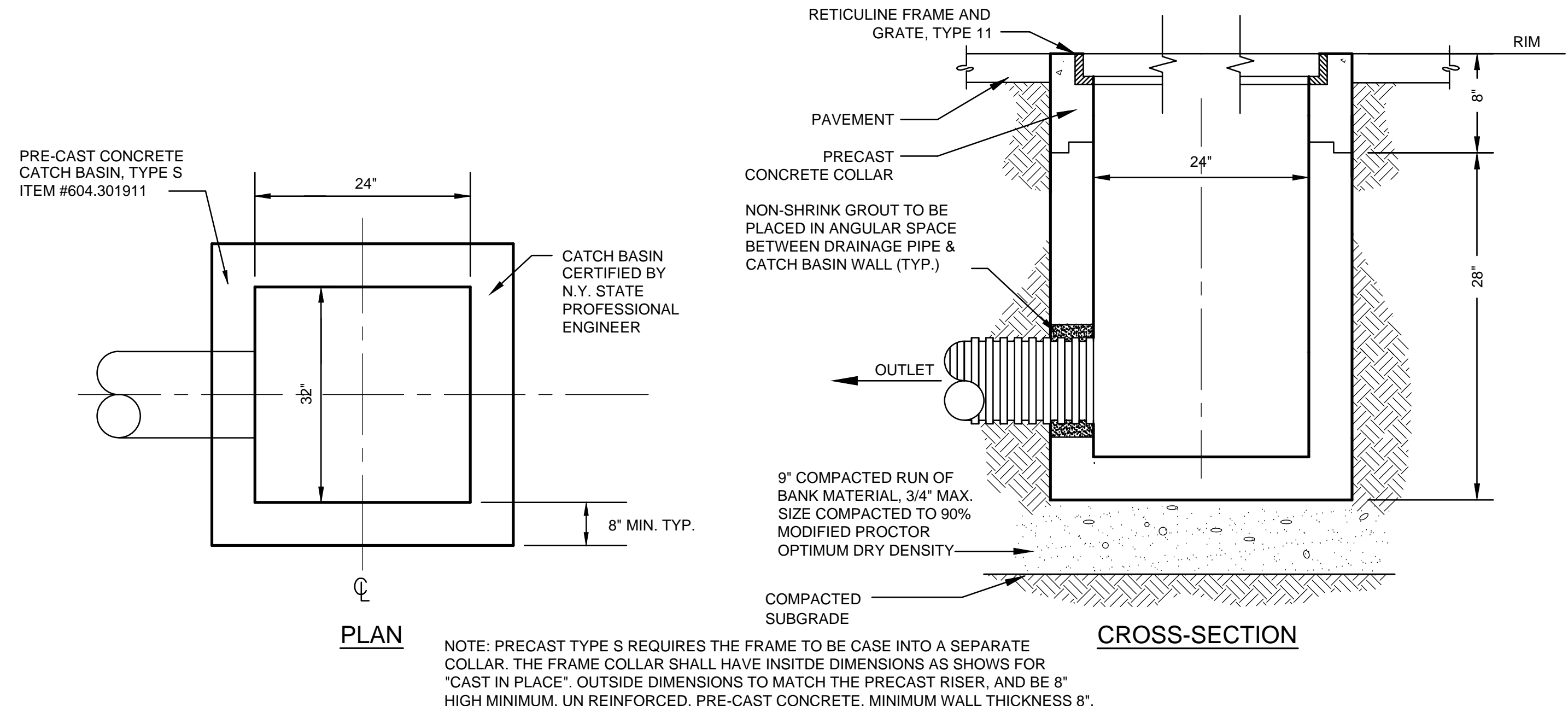
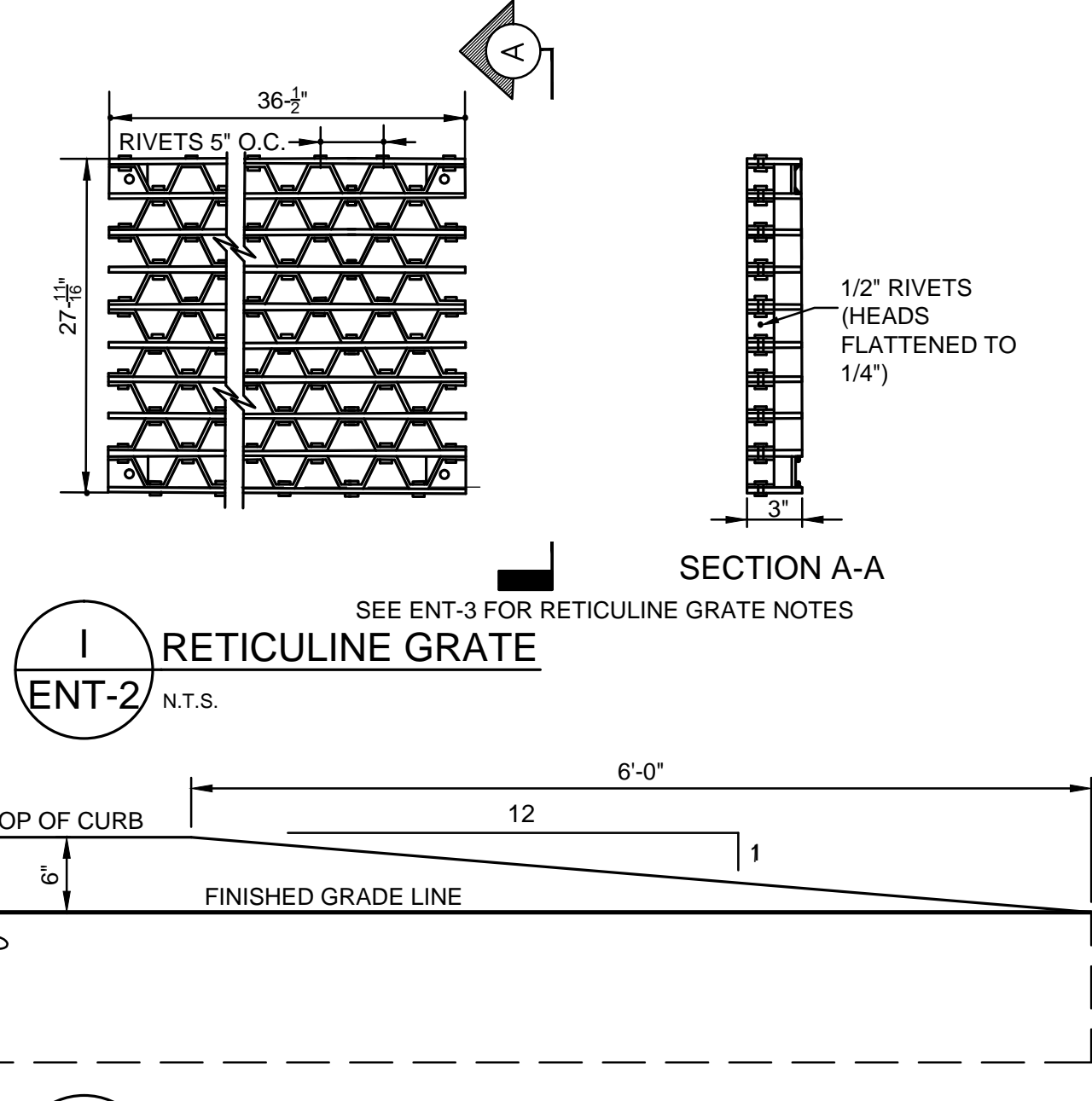

3	REVISED PER NYSDOT COMMENTS	11-09-16	ETV
2	REVISED PER UPDATED ITEM NUMBERS	09-09-16	ETV
1	REVISED PER DOT COMMENTS	12-22-11	CJK
REV. No.	ZONE	DATE	BY

**CLAVERACK FREE LIBRARY**  
TOWN OF CLAVERACK COLUMBIA COUNTY, NY

**NYSDOT ENTRANCE DETAIL SHEET #1**

**CRAWFORD & ASSOCIATES**  
ENGINEERING, P.C.  
551 Warren Street, Hudson New York 12534  
www.crawfordandassociates.com

IT IS A VIOLATION OF THE NEW YORK STATE EDUCATION LAW FOR ANY PERSON TO ALTER THESE PLANS, SPECIFICATIONS OR REPORTS IN ANY WAY, UNLESS HE IS ACTING UNDER THE DIRECTION OF A LICENSED PROFESSIONAL ENGINEER.

DATE	DRAWN BY:	CJK	11-09-16 NYSDOT ENTRANCE-09g
9/19/11	DESIGNED BY:	CJK	
SCALE	CHECKED BY:	APA	C&A JOB#
AS SHOWN	APPROVED BY:	APA	4721.0
			DRAWING: ENT-2



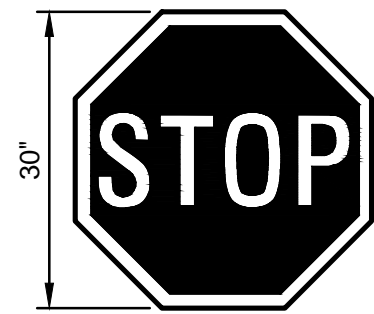

MUTCD / NYS SUPPLEMENT #: R1-1

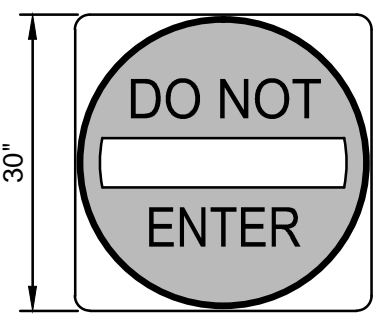

MUTCD / NYS SUPPLEMENT #: R5-1

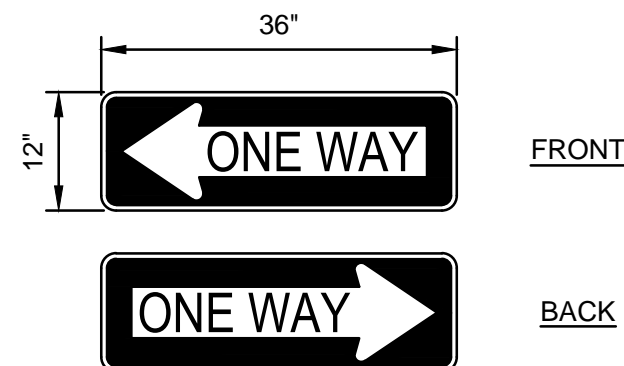

MUTCD / NYS SUPPLEMENT #: R6-1

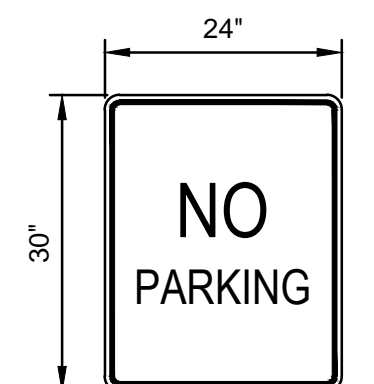

MUTCD / NYS SUPPLEMENT #: R8-3A

**NOTES:**

- ALL SIGNAGE SHALL BE SIZED AND OTHERWISE CONSTRUCTED IN ACCORDANCE WITH THE LATEST USDOT / FEDERAL HIGHWAY ADMINISTRATION MANUAL OF UNIFORM TRAFFIC CONTROL DEVICES (MUTCD) AND THE NYS SUPPLEMENT.
- ONE WAY SIGN R6-1 SHALL BE CONSTRUCTED WITH FRONT AND BACK SIDES PLACED BACK TO BACK WITH ARROWS ALIGNED SUCH THAT SIGN IS VISIBLE FROM BOTH DIRECTIONS OF TRAVEL.
- SEE DETAIL B/ENT-3 FOR BREAKAWAY SIGN POST MOUNTING.

**A** MUTCD / NYSDOT SIGNAGE DETAIL  
ENT-3 N.T.S.

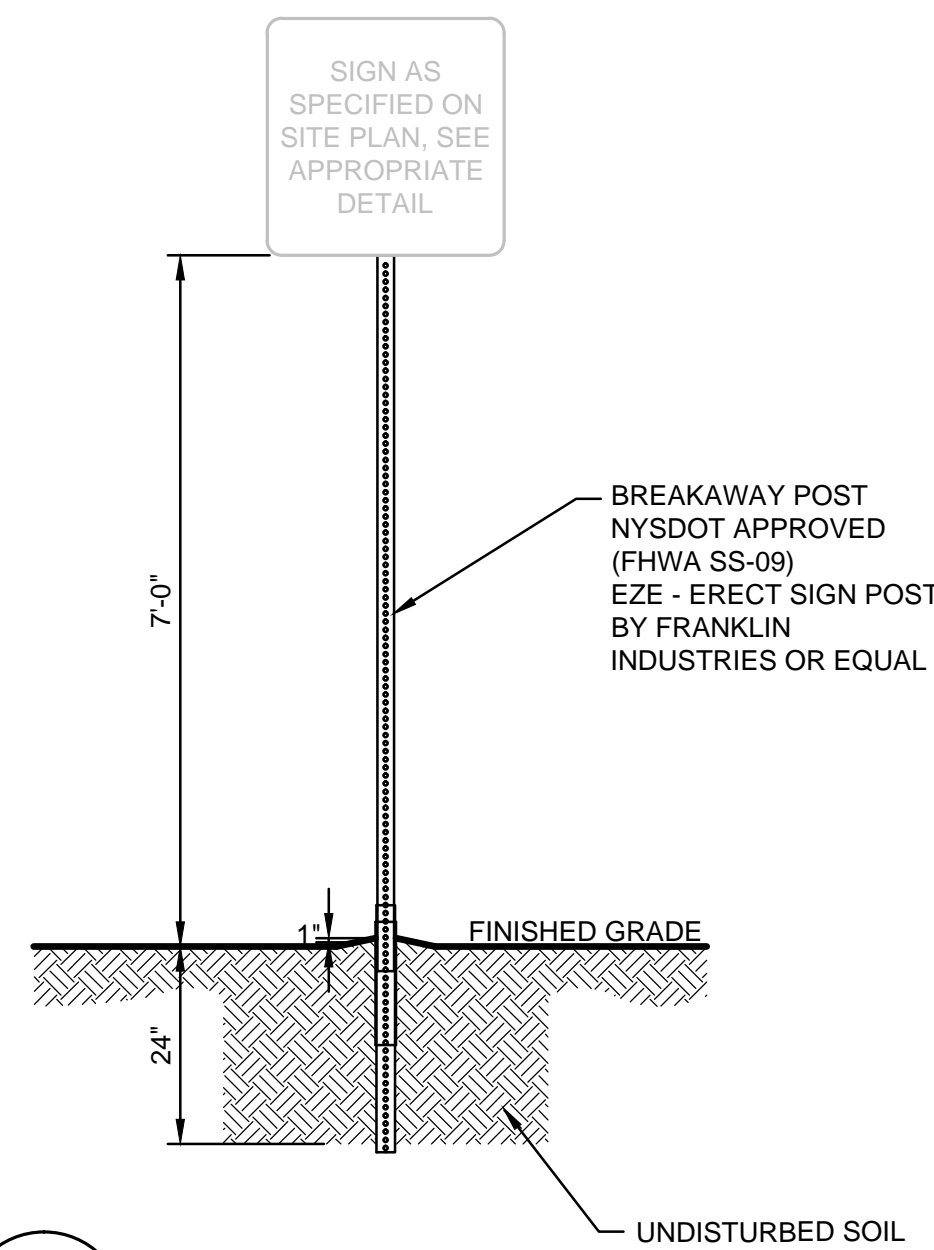

**B** BREAKAWAY SIGN POST DETAIL  
ENT-3 N.T.S.

**GENERAL NOTES:**

- AS PER NYS CODE RULE 753, THE CONTRACTOR SHALL PROVIDE DUE AND TIMELY NOTICE TO "DIG SAFELY NEW YORK" AT 1-800-962-7962 AT LEAST TWO WORKING DAYS PRIOR TO COMMENCING DEMOLITION OR EXCAVATION. THE CONTRACTOR SHALL COMPLY WITH ALL REQUIREMENTS OF THE NYS CODE RULE 753. UPON DISCOVERY OF UNKNOWN UNDERGROUND FACILITIES, CABLING, ETC. WORK IN THAT AREA SHALL CEASE. NOTIFY UFPO, OWNER AND ENGINEER IMMEDIATELY. DO NOT PROCEED WITH WORK UNTIL RECEIVING WRITTEN DIRECTION TO DO SO FROM THE OWNER'S PROJECT REPRESENTATIVE.
- ALL EXCAVATIONS SHALL BE BRACED IN ACCORDANCE WITH THE PROVISIONS OF THE OCCUPANCY SAFETY AND HEALTH ADMINISTRATION "STANDARDS FOR THE CONSTRUCTION INDUSTRY, 29 CFR PART 1926-SUB PART P - EXCAVATIONS".
- ANY EXCAVATION WHICH EXCEEDS FIVE FEET IN DEPTH AND HAS LIVE TRAFFIC OR UTILITIES WITHIN 1V:1H PROJECTION FROM THE BOTTOM OF THE EXCAVATION SHALL UTILIZE A SHEETING/SHORING SYSTEM WHICH PROVIDES DIRECT CONTACT AND SUPPORT OF THE EXCAVATION SIDES (A TRENCH BOX DOES NOT MEET THESE REQUIREMENTS). THE CONTRACTOR SHALL PROVIDE VERIFICATION (I.E., MANUFACTURER'S DATA SHEETS AND/OR P.E. DESIGN COMPUTATIONS) TO THE NYSDOT THAT THE SYSTEM CHOSEN CAN ACCOMMODATE THE ANTICIPATED SOIL, WATER, TRAFFIC, AND SURCHARGE LOADINGS.

**TEMPORARY LANE NARROWING:**

IT WILL BE NECESSARY TO TEMPORARILY NARROW TRAVEL LANES IN ORDER TO PERFORM THE CONTRACT WORK. THE FOLLOWING RESTRICTIONS SHALL APPLY TO LANE NARROWING:

- NO LANE NARROWING SHALL BE PERMITTED WITHOUT PRIOR APPROVAL OF THE ENGINEER-IN-CHARGE (EIC).
- THE STATE RESERVES THE RIGHT TO ALLOW WORK WITHIN THE CONTRACT LIMITS BY OTHERS ALONG KEY CORRIDORS. IN ORDER TO MINIMIZE INCONVENIENCE TO THE TRAVELING PUBLIC, ANY LANE CLOSURES REQUIRED WITHIN CONTRACT LIMITS MUST BE APPROVED BY THE SURFACE TRANSPORTATION CONTROLLER (STC). KEY CORRIDORS ARE DEFINED AS I-684, TACONIC STATE PARKWAY (TSP), PALISADES INTERSTATE PARKWAY (PIP), SPRAIN BROOK PARKWAY (SBP), SAW MILL RIVER PARKWAY (CCP), NYS RTE. 17 (FUTURE I-86), I-84 (INCLUDING THE NEWBURGH-BEACON BRIDGE), I-87 (INCLUDING THE TAPPAN ZEE BRIDGE), I-287, I-95 AND I-90.

THE CONTRACTORS' ATTENTION IS DIRECTED TO THE FACT THEY ARE RESPONSIBLE TO FORWARD REQUESTS THROUGH THE EIC TO THE STC FOR LANE CLOSURE APPROVALS. THESE REQUESTS MUST BE SUBMITTED TO THE STC AT THE EMAIL ADDRESS: STC-R08@DOT.STATE.NY.US, A MINIMUM OF SEVEN (7) DAYS IN ADVANCE OF SCHEDULED CLOSURES. THE STC SHALL RESPOND WITHIN FOUR BUSINESS DAYS OF RECEIPT OF REQUEST. ATTENTION IS ALSO DIRECTED TO THE FACT THAT, DUE TO POSSIBLE TRAFFIC CONTROL CONFLICTS, APPROVAL MAY OR MAY NOT BE GRANTED FOR THE DATE(S) REQUESTED. ANY ADDITIONAL COSTS, DELAYS OR REMOBILIZATIONS ASSOCIATED WITH THE APPROVAL PROCESS SHALL BE INCLUDED IN THE BID PRICE FOR BASIC WORK ZONE TRAFFIC CONTROL.

- NO LANE NARROWING WILL BE PERMITTED DURING NON-WORKING HOURS, UNLESS SPECIFICALLY PROVIDED ELSEWHERE IN THE CONTRACT.
- ON KEY CORRIDORS AS DESCRIBED IN NOTE 1 ABOVE THE REQUIRED NUMBER OF LANES BY TIME OF DAY CHART IN THE PROPOSAL SHALL BE FOLLOWED. ON ALL OTHER ROUTES THE SAME NUMBER OF TRAVEL LANES (INCLUDING TURNING LANES), AS EXIST PRIOR TO THIS CONTRACT, SHALL BE MAINTAINED IN EACH DIRECTION DURING THE HOURS OF 7:00 AM TO 9:00 AM AND 4:00 PM TO 6:00 PM - MONDAY TO FRIDAY, INCLUSIVE.
- IN AREA OF MAJOR SHOPPING MALLS, THE SAME NUMBER OF TRAVEL LANES (INCLUDING TURNING LANES), THAT EXIST PRIOR TO THIS CONTRACT, SHALL BE MAINTAINED IN EACH DIRECTION DURING THE HOURS OF 10:00 AM TO 4:00 PM ON SATURDAYS.
- THE TIME RESTRICTIONS LISTED ABOVE CAN BE SHIFTED AS TRAFFIC CONDITIONS WARRANT, AND THE CONTRACTOR SHALL BE AWARE THE THE EIC HAS THE ABILITY TO ORDER ADDITIONAL TIME RESTRICTIONS OF UP TO ONE HOUR PER WORK DAY TO THE TIME RESTRICTIONS LISTED ABOVE IF TRAFFIC CONDITIONS WARRANT, AT NO COST TO THE STATE. THE CONTRACTOR SHALL NOT HAVE ANY DELAY CLAIMS AGAINST THE STATE IF THE EIC ORDERS UP TO ONE HOUR OF ADDITIONAL TIME RESTRICTIONS PER DAY.
- THE EIC IS AUTHORIZED TO REDUCE THE ABOVE TIME RESTRICTIONS ON THE NON-KEY CORRIDORS AS TRAFFIC CONDITIONS WARRANT.
- THE CONTRACTOR'S ATTENTION IS DIRECTED TO THE FACT THAT THE FOLLOWING HOLIDAY WORK RESTRICTIONS ARE APPLICABLE TO THIS PROJECT. DURING THESE HOLIDAY PERIODS, THE CONTRACTOR WILL NOT BE ALLOWED TO PERFORM ANY WORK THAT WILL BE DISRUPTIVE TO TRAFFIC, INCLUDING BUT NOT LIMITED TO LANE CLOSURES. LANE CLOSURES WILL NOT BE PERMITTED DURING THE FOLLOWING STATE RECOGNIZED HOLIDAYS:

NEW YEAR'S DAY	MEMORIAL DAY
INDEPENDENCE DAY	LABOR DAY
THANKSGIVING DAY	CHRISTMAS DAY

IF THE HOLIDAY IS ON A MONDAY, NO LANE CLOSURES WILL BE PERMITTED FROM 12 NOON FRIDAY TO 10 AM TUESDAY. IF THE HOLIDAY IS ON A TUESDAY, NO LANE CLOSURES WILL BE PERMITTED FROM 12 NOON FRIDAY TO 10 AM WEDNESDAY. IF THE HOLIDAY IS ON A WEDNESDAY, NO LANE CLOSURES WILL BE PERMITTED FROM 12 NOON TUESDAY TO 10 AM THURSDAY. IF THE HOLIDAY IS ON A THURSDAY OR FRIDAY, NO LANE CLOSURES WILL BE PERMITTED FROM 12 NOON THE DAY BEFORE THE HOLIDAY TO 10 AM MONDAY. IF THE HOLIDAY IS ON A WEEKEND DAY, NO LANE CLOSURES WILL BE PERMITTED FROM 12 NOON FRIDAY TO 10 AM MONDAY.

- THE CONTRACTOR IS ALSO ADVISED THAT THE STATE RESERVES THE RIGHT TO PRECLUDE LANE NARROWING DURING PERIODS OF INCLEMENT WEATHER, WET OR ICY PAVEMENT, REDUCED VISIBILITY, TRAFFIC ACCIDENTS OR ANY OTHER EMERGENCIES. THE STATE MAY ALTER ANY LANE CLOSURES SHOULD TRAFFIC CONDITIONS OR OTHER UNFORESEEN CIRCUMSTANCES ARISE WHICH WOULD ADVERSELY AFFECT THE TRAFFIC FLOW. THE CONTRACTOR IS ALSO ALERTED TO THE FACT THAT INCIDENT MANAGEMENT OR TRAFFIC CONDITIONS MIGHT FORCE HISHER CONSTRUCTION OPERATION TO STOP. EVEN DURING TIME WHERE SUCH OPERATION WOULD NORMALLY BE PERMITTED. TEN SUCH OCCURRENCES PER CALENDAR YEAR SHOULD BE TAKEN INTO CONSIDERATION AS A REASONABLE FREQUENCY OF SUCH EVENT WHEN BIDDING THIS PROJECT. THE CONTRACTOR SHALL HAVE NO CLAIM AGAINST THE STATE FOR ANY DELAYS OR EXTRA COSTS INCURRED IN COMPLYING WITH THESE RESTRICTIONS.

THE STATE MAY GRANT A WAIVER OF THESE RESTRICTIONS UPON A TIMELY RECEIPT OF A REQUEST FOR SAID WAIVER FROM THE CONTRACTOR. A MINIMUM OF FIVE WORKING DAYS FOR THE REVIEW OF THE CONTRACTORS REQUEST WILL BE REQUIRED.

**SPECIAL NOTE FOR HIGHWAY WORK PERMIT:**

- AS A CONDITION OF THIS PERMIT, PERMITTEE AGREES THAT THE PROPOSED DEVELOPMENT OF THE REAL PROPERTY TO WHICH ACCESS IS PROVIDED PURSUANT TO THE TERMS HEREOF, AND ALL FUTURE DEVELOPMENT OF SUCH PROPERTY, SHALL BE PLANNED AND DESIGNED SO THAT THE ACCESS PROVIDED HEREIN SHALL BE THE ONLY NECESSARY ACCESS FROM THE STATE HIGHWAY(S) AND THAT PERMITTEE SHALL NOT BY SALE, LEASE OR OTHER BUSINESS ARRANGEMENT CREATE ANY CONDITION WHEREBY OTHER ACCESS TO OR FROM THE STATE HIGHWAY(S) BECOMES NECESSARY.

**PROTECTION OF PUBLIC:**

- THE CONTRACTOR WILL BE RESPONSIBLE FOR NOTIFYING INDIVIDUALS OF CONSTRUCTION THAT WILL AFFECT THE ACCESS TO AND FROM THEIR RESIDENCE OR PLACE OF BUSINESS. THE CONTRACTOR MUST PROVIDE TEMPORARY ACCESS FROM THAT RESIDENTIAL/COMMERCIAL BUSINESS DURING CONSTRUCTION.
- THE TEMPORARY ACCESS WAYS SHALL MEET THE NEED OF THE RESIDENTS/COMMERCIAL BUSINESS THAT THEY ARE ESTABLISHED FOR, AND SHALL PROVIDE A SAFE AND ADEQUATE MEANS OF TRANSPORT.

**RETICULINE GRATE NOTES:**

- GRATES ARE DESIGNED 16,000 POUND WHEEL LOAD (HS 20 LOADING.)
- CUP ANGLES SHALL BE CUT FROM STANDARD ASTM A6 ANGLES OR FORMED FROM A 114 X 13 BAR. THE ALTERNATE DESIGN SHALL BE FORMED FROM A 114 X 13 BAR.
- GRATE SHALL BE GROUND TO FIT FILLETS IN FRAME ANGLES OR CASTINGS.
- WELDS ON OUTSIDE OF GRATE SHALL BE GROUND SMOOTH.
- WELDS AND ADJACENT AREAS SHALL BE SAND OR SHOT BLASTED BEFORE GALVANIZING IN ORDER TO REMOVE ALL SCALE, RUST SLAG, AND SPLATTER.
- GRATES SHALL BE HOT-DIP GALVANIZED AFTER ALL FABRICATION, GRINDING, TAPPING, AND CLEANING HAVE BEEN COMPLETED.
- GRATE SHALL BE BOLTED TO WELDED FRAME WITH FOUR M16X2X6.5mm (OR EQUIVALENT) BOLTS AND WASHERS, ONE IN EACH CORNER. BOLTS AND WASHERS SHALL BE CORROSION RESISTANT (MONTEL METAL OR TYPE 316 STAINLESS STEEL) AND FURNISHED BY THE FRAME MANUFACTURER.

**LANDSCAPE, ADA & ENVIRONMENTAL NOTES:**

- ALL DISTURBED AREAS WITHIN THE STATE R.O.W. ARE TO BE TOPSOILED, SEEDED AND MULCHED TO GUARANTEE AN ACCEPTABLE STAND OF GRASS.
- NO TREES WITHIN THE STATE R.O.W. OVER 6" D.B.H. (DIAMETER BREAST HEIGHT) ARE TO BE REMOVED WITHOUT PRIOR PERMISSION FROM THE REGIONAL LANDSCAPE ARCHITECT/OFFICE. THE REGIONAL LANDSCAPE ARCHITECT/OFFICE MAY BE CONTACTED AT (845) 431-5853.
- ACCEPTABLE ISLAND TREATMENTS OR OTHER LANDSCAPE AREAS ARE:
  - MAINTAINED TURF.
  - ORGANIC MULCH WITH OR WITHOUT PLANTS.
    - PLANTS, AT THEIR MATURE HEIGHT, SHALL NOT INVADE THE SIGHT DISTANCE REQUIREMENTS OF DRIVEWAYS. PLANTS MUST BE 2 FEET OR LESS IN HEIGHT ABOVE THE DRIVEWAY PAVEMENT (18" ABOVE 6" CURB).
  - CONCRETE PAVERS/LANDSCAPE BRICK.
    - FLUSH CHANNELIZING ISLANDS IN LIEU OF LARGE ASPHALT DRIVEWAYS WITH PAVEMENT MARKINGS MUST BE DESIGNED & CONSTRUCTED TO SUPPORT TRAFFIC LOAD OF LARGE VEHICLE TURN PATHS.
  - CONCRETE (IF FOR SIDEWALK, 5 FEET + SPACE FOR SIGNS MINIMUM BETWEEN CURBS).
  - COMBINATIONS OF THESE.
  - LANDSCAPE PLANTING DETAILS SHALL COMPLY WITH NYSDOT STANDARD SHEET M611-1.
- UNACCEPTABLE ISLAND TREATMENTS OR OTHER LANDSCAPED AREAS ARE:
  - ASPHALT
  - LOOSE STONE/GRAVEL OF ANY SIZE.
- APPLICANT/PERMITTEE AGREES TO MAINTAIN LANDSCAPING ON NYSDOT ROW.
  - BLOWING OF HAZARDOUS DEBRIS (DUST, DIRT, LEAVES, ETC.) WITH ANY KIND OF FORCE TOWARDS THE STATE HIGHWAY, OTHER PUBLIC ROADWAY OR DRIVEWAY ENTRANCES IS PROHIBITED. LEAF BLOWERS OR OTHER POWER TOOLS THAT CAN INTERFERE WITH TRAFFIC, DAMAGE A VEHICLE/BICYCLE/PROPERTY OF HIGHWAY USERS OR CAUSE INJURY TO PERSONS ARE NOT PERMITTED FOR MAINTENANCE OPERATIONS. MAINTENANCE SHALL INCLUDE NORMAL MANUAL LANDSCAPE TYPE LABOR.
- ALL SIDEWALK CURB RAMPS AND DETECTABLE WARNING SURFACES SHALL BE AS PER:
  - NYSDOT STANDARD SHEETS
 

M608-10 - SIDEWALK CURB RAMPS SHEET 1 OF 4	DIMENSIONS, DETAILS AND GEOMETRY CONFIGURATIONS
M608-11 - SIDEWALK CURB RAMPS SHEET 2 OF 4	CONFIGURATIONS
M608-12 - SIDEWALK CURB RAMPS SHEET 3 OF 4	CONFIGURATIONS
M608-13 - SIDEWALK CURB RAMPS SHEET 4 OF 4	DETECTABLE WARNING DETAILS
  - NYSDOT SPECIAL SPECIFICATIONS
 

ITEM 608-5.06 - SURFACE APPLIED DETECTABLE WARNING
ITEM 608-5.07 - EMBEDDED PERFORMANCE DETECTABLE WARNING UNIT
ITEM 608-5.08 - STAMPED DETECTABLE WARNING
- OTHER ACCESSIBLE REQUIREMENTS SHALL BE AS PER:
  - ENGINEERING INSTRUCTION 92-006 - ACCESSIBLE BUS STOPS
  - NYSDOT STANDARD SHEET M608-4R1 - ACCESSIBLE PARKING FOR PERSONS WITH DISABILITIES
- PAVEMENT MARKINGS FOR CROSSWALK & STOP LINES ARE AS PER NYSDOT STANDARD SHEETS M685 SERIES, THE LATEST VERSIONS. STOP LINES ARE ON STANDARD SHEET M685-1 AND CROSSWALKS ARE ON STANDARD SHEET M685-2R1.

**EMERALD ASH BORER NOTES:**

CLEARING AND GRUBBING OPERATIONS MAY RESULT IN THE REMOVAL OF ASH TREE (FRAXINUS SPP.). IT IS UNLAWFUL TO TRANSPORT ANY ASH MATERIAL FROM A PROJECT SITE THAT IS LOCATED IN AN AREA THAT HAS BEEN QUARANTINED FOR EMERALD ASH BORER BY THE NEW YORK STATE DEPARTMENT OF ENVIRONMENTAL CONSERVATION (CURRENTLY, ULSTER COUNTY IS THE ONLY COUNTY IN REGION 8 THAT IS QUARANTINED). THEREFORE, UNDER NO CIRCUMSTANCE IS THE CONTRACTOR TO REMOVE ANY ASH LOG OR ASH STUMP FROM THE PROJECT SITE. INSTEAD, ALL ASH BRANCHES, TRUNKS, ROOTS, AND ALL VEGETATIVE PARTS ARE TO BE CHIPPED TO 1X1 INCH CHIPS. ASH STUMPS CAN BE GROUND 6 INCHES BELOW GRADE OR IF GRUBBED, ROOTS MUST BE CHIPPED TO 1X1 INCH CHIPS. THE CONTRACTOR SHALL SPREAD THESE WOOD CHIPS ON-SITE IN LOCATIONS DETERMINED BY THE ENGINEER IN CHARGE.

**REQUIREMENTS FOR WINTER EARTHWORK OPERATION WITHIN NEW YORK STATE RIGHT-OF-WAY FOR ALL PERMITS:**

ALL PERMIT WORK UNDER CONSTRUCTION BETWEEN THE DATES OF NOVEMBER 1 THROUGH APRIL 1 SHALL CONFORM TO THE FOLLOWING ADDITIONAL REQUIREMENTS:

- GRANULAR OR OTHER FROST SUSCEPTIBLE MATERIAL SHALL NOT BE PLACED WHEN THE TEMPERATURE IS BELOW 32 DEGREES FAHRENHEIT.
- FROZEN MATERIAL SHALL NOT BE INCORPORATED INTO EMBANKMENTS OR BACKFILLS.
- MATERIAL SHALL NOT BE PLACED ON FROZEN GROUND.
- THE MATERIAL SHALL BE COMPACTED IN ACCORDANCE WITH "SUPPLEMENTAL REQUIREMENTS FOR UNDERGROUND INSTALLATIONS WITHIN THE STATE HIGHWAY RIGHT-OF-WAY".
- ANY SPECIAL CONDITIONS AND RESTRICTIONS AS MAY BE IMPOSED BY THE RESIDENT ENGINEER OR THE REGIONAL SOILS ENGINEER.

**SPECIAL NOTES:**

- MAINTENANCE AND PROTECTION OF TRAFFIC IS THE RESPONSIBILITY OF THE PERMITTEE. ANY SUBCONTRACTORS WORKING FOR THE PERMITTEE MUST HAVE A COPY OF THE HIGHWAY WORK PERMIT ON THE SITE AND MUST BE FAMILIAR WITH THE TRAFFIC CONTROL REQUIREMENTS. IT IS STRONGLY ADVISED THAT A "TAILGATE" SAFETY MEETING WITH EACH WORK CREW BE INITIATED BEFORE THE START OF WORK.
- TRAFFIC CONTROL SCHEMES MUST BE IN PLACE, AND MAINTAINED, THROUGHOUT THE DURATION OF WORK.
- ALL MAINTENANCE AND PROTECTION OF TRAFFIC TO BE IN ACCORDANCE WITH THE NATIONAL MANUAL OF UNIFORM TRAFFIC CONTROL DEVICES AND THE NYS SUPPLEMENT.
- ANYONE WORKING WITHIN THE HIGHWAY RIGHT-OF-WAY SHALL WEAR HIGH-VISIBILITY APPAREL MEETING THE ANSI 107-2004 CLASS II STANDARDS AND A HARD HAT.
- AT THE START OF WORK ON THE PROJECT, ALL WORK ZONE TRAFFIC CONTROL DEVICES SHALL APPEAR IN "ACCEPTABLE" CONDITION. THESE DEVICES SHALL NOT BE ALLOWED TO FALL BELOW THE "MARGINAL" CONDITION AT ANY TIME DURING THE LIFE OF THE PROJECT. FADED AND DETERIORATED PANELS AND NON-STANDARD LEGENDS ARE NOT ACCEPTABLE.
- FLAGGER SIGNS ARE TO BE USED ONLY WHEN A FLAGGER IS ACTUALLY PRESENT AND VISIBLE TO THE MOTORIST. THEY SHALL BE COVERED OR REMOVED AT ALL OTHER TIMES. STOP/SLOW PADDLES ARE REQUIRED.
- NO LOW-MOUNTED SIGNS SHALL BE PERMITTED, EXCEPT FOR FLEXIBLE PANELS MEETING THE CURRENT SPECIFICATION REQUIREMENTS.

3	REVISED PER NYSDOT COMMENTS	11-09-16	ETY
2	REVISED PER UPDATED ITEM NUMBERS	09-09-16	ETY
1	REVISED PER DOT COMMENTS	12-22-11	CJK
REV. No.	ZONE	DATE	BY

CLAVERRACK FREE LIBRARY  
TOWN OF CLAVERRACK COLUMBIA COUNTY, NY

NYSDOT ENTRANCE DETAIL SHEET #2

**CRAWFORD & ASSOCIATES**  
ENGINEERING, P.C.  
551 Warren Street, Hudson New York 12534  
www.crawfordandassociates.com  
tel: (518) 828-2700  
fax: (518) 828-2723

DATE	DRAWN BY:	CJK	FILE: WORK\4721.0.dwg\11.09.16 NYSDOT ENTRANCE.dwg
9/19/11	DESIGNED BY:	CJK	
SCALE	CHECKED BY:	APA	C&A JOB# 4721.0
AS SHOWN	APPROVED BY:	APA	DRAWING: ENT-3

IT IS A VIOLATION OF THE NEW YORK STATE EDUCATION LAW FOR ANY PERSON TO ALTER THESE PLANS, SPECIFICATIONS OR REPORTS IN ANY WAY, UNLESS HE IS ACTING UNDER THE DIRECTION OF A LICENSED PROFESSIONAL ENGINEER.

COPYRIGHT